



FOYER GALLERY EXHIBITION PROPOSAL GUIDE

The Foyer Gallery

Located within Gosford Regional Gallery, the Foyer Gallery is an exhibition space for emerging and established regional and national artists. It has 26 linear metres/ 197 m² of exhibition space. Exhibitions generally run for four to five weeks and they are curated, installed and deinstalled by gallery staff. A committee of the Gosford Regional Gallery reviews Foyer Gallery proposals twice a year. They are selected according to the strategic objectives of the Gallery.

Deadlines

3 October 2011 Deadline for submissions for October assessment meeting (exhibitions for 2013)
2 April 2012 Deadline for submissions for April assessment meeting (exhibitions for 2013/2014)

Your proposal should include:

- 1) Foyer Gallery Proposal Cover Sheet – attached below
- 2) Exhibition proposal – this should include:
 - a. Explanation of the theme or premise of the exhibition
 - b. Explanation of how the exhibition relates to the goals and objectives of the gallery (see General Information About Gosford Regional Gallery below)
 - c. List of works – including: Artist, Title, Date, Medium, Dimensions for each work
 - d. Preferred exhibition dates – these should be as broad as possible
 - e. Description of any special requirements including equipment, handling requirements, installation materials and costs etc
- 3) CV (Curriculum Vitae) and artist's statement for each artist and curator (if any) involved in the exhibition
- 4) Images of the artist(s) work and an image list

Submission Process:

Proposals should be submitted to: **The Curator, Gosford Regional Gallery, 36 Webb Street, East Gosford NSW 2260** or emailed to gallery@gosford.nsw.gov.au. They are assessed by a committee of the Gosford Regional Gallery twice a year. They are selected according to the strategic objectives of the Gallery.

GENERAL INFORMATION ABOUT GOSFORD REGIONAL GALLERY

Background

The Gosford Regional Gallery is located on the shores of Caroline Bay in East Gosford. It is part of a complex that also includes the Gosford/Edogawa Commemorative Garden, the Arts Centre and the Caroline Bay Brasserie, Cafe & Function Centre.

The gallery was officially opened in April 2000 and since then has been visited by approximately 160,000 people each year. Although the gallery does not have a permanent collection, a diverse and stimulating exhibition program has been maintained, consisting of a range of local, national and international exhibitions of various media including painting, photography, sculpture, textiles, ceramics, and works on paper. The gallery has quickly become an important cultural and educational resource for the Central Coast community.

Mission Statement:

To create an environment in which the visual arts are celebrated throughout the Central Coast region. The Gosford Regional Gallery and Arts Centre Incorporating the Gosford Edogawa Commemorative Garden will be a Centre of arts excellence and innovation, reflecting and fostering community interest, understanding and participation in the visual arts.

Aims:

- To provide a regional art gallery of approved conservation standard to allow the staging of exhibitions of regional, national and international significance
- To professionally stage exhibitions of contemporary and historic significance
- To offer professional education services to all areas of the community, particularly students.
- To foster community involvement, understanding and participation in the visual arts in the City of Gosford and across the Central Coast region
- To encourage local artists and crafts people
- To support and promote the sister city relationship with Edogawa and to facilitate opportunities for cultural exchange
- To market and promote the Gosford Regional Gallery and Arts Centre Incorporating the Gosford Edogawa Commemorative Garden as a cultural resource which will be of educational and recreational benefit to the local community and visitors to the Central Coast

FOYER GALLERY FLOOR PLAN:

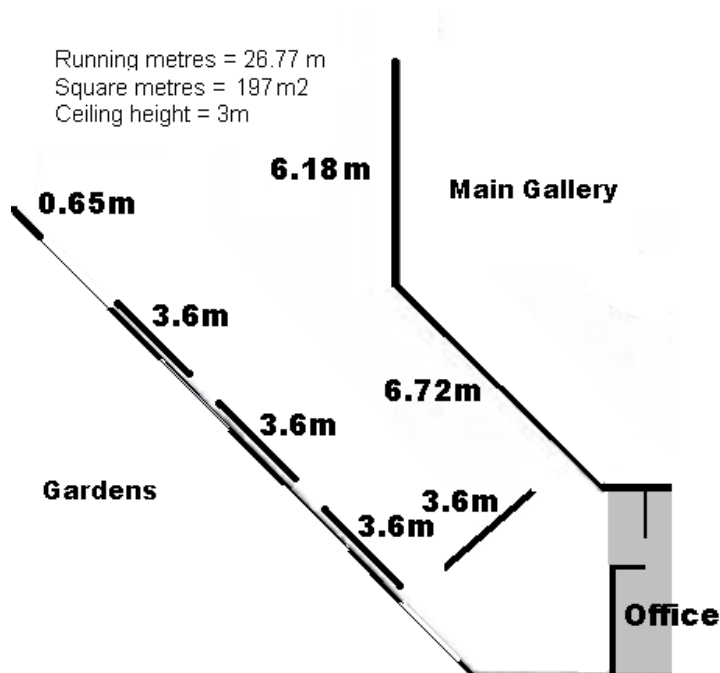



FOYER GALLERY EXHIBITION PROPOSAL- COVER SHEET

Contact person:

Name:

Organisation (if any):

Address:

Ph (Home)

Phone (Work)

Phone (Mobile)

Email:

Title of proposed exhibition:

All exhibiting artists' names:

Availability:

Please list the date range that the artworks will be available for the exhibition. Please note, exhibitions in the Foyer Gallery generally run for four to five weeks and are programmed by Gallery staff up to two years in advance. Your preferred dates may not be available – so please list a range of dates.